



川源(中国)机械有限公司
GSD (China) Co., Ltd.



QW

沉水式污物(泥)泵

QW submersible solid handling pump

QW 沉水式污物(泥)泵

QW submersible solid handling pump



用途 Application

- 废水扬升站
 - 都市废水处理厂
 - 化粪池排水系统
 - 医院、学校、社区等生活废水处理系统
 - 食品、造纸、采矿、纺织、皮革、化学工厂等工业之废水处理系统
 - 净水处理系统
- Wastewater lift station.
 - Municipal wastewater treatment plant.
 - Building wastewater treatment system.
 - Hospital, school, community, etc. wastewater treatment system.
 - Food, paper, mining, textile, leather, chemical industry, etc. wastewater treatment system.
 - Water purification system.

特点 Features

- **电机和能效**
电机采用F级绝缘，防护等级IP68。
水泵效率达到国内一流水平，QW产品通过CQC中国质量认证中心节能产品认证，符合国家一级能效标准要求。
- **机械密封**
机械密封的作用是阻绝抽送介质与电动机部分接触，双机械密封串联相互独立工作，为电动机提供双重保护。



- **Motor and Energy Efficiency**
Insulation class F and protection grade IP68 .
The efficiency of the water pump has reached the first-class level in China, and QW products in the series have passed the energy-saving product certification of CQC(China Quality Certification Center), meeting the requirements of Energy Efficiency Grade 1.
- **Mechanical seal**
The mechanical seals protect the motor from contacting the pumping liquids. Two seals are in series with each other and individually work to provide the motor with a dual protection.

■ 测漏检知器

油室测漏检知器，检测密封不良或机械密封损坏导致的泄漏。≤11kW机型可选配，>11kW机型标配。接线盒和电机腔测漏检知器，可检测泄漏并触发报警，联动控制系统保护泵。≥11kW机型可额外选配。

■ 过热保护器

在电动机中加装过热保护器，对过载、温升等状况自动进行检测，避免由于电动机过热造成电机烧毁（≤11kW选用配备，>11kW标准配备）。

在轴承中加装过热保护器，当轴承温度升至断开温度时，保护器自动切断电源，起到保护轴承的作用（非标准配备，≥11kW可选配）。

■ 水冷夹套（选用配备）

泵工作时利用泵腔内压力使液体连续进入水冷夹套与电动机外壳的空间以带走电动机产生的热量，从而保证水泵在低水位正常工作（≥11kW可选配）。

■ 智能潜污泵说明

川源从服务用户出发，≥11kW可安装智能潜污泵系统 - 实现水泵智能化运行和健康管理。

智能潜污泵系统比传统用泵可节省40-60%的运维人力投入。

智能潜污泵系统可有效降低40%以上的设备备品备件数量。

智能潜污泵系统通过优化运行工况参数，节省30%以上的设备能耗。

■ Leakage detector

Oil chamber leakage detector, detects leaks caused by poor sealing or damaged mechanical seal. Optional for models ≤ 11kW, and standard for models >11kW.

Junction box and motor cavity leakage detector, detects leaks and triggers alarms, linking the control system to protect the pump. It can be additionally equipped for models ≥11kW.

■ Heat-protector

Built-in heat protector in motor, can prevent the motor from burning out, overload & overheating. (Less than 11 kW options, No less than 11 kW standard).

Built-in heat protector in bearing, when the bearing is abnormal and the temperature rises to disconnecting temperature, the protector automatically cut off power supply to protect the bearing. (Not standard, no less than 11 kW options).

■ Cooling house (options)

Pumps make use of inner pressure of pump cavity to make liquid continually entering in space between cooling house and motor outer, to take away the heat of the motor, to make sure the regular work of the pump in low water level (No less than 11 kW options).

■ Intelligent submersible pump description

GSD starts from serving customers, the submersible pumps ≥ 11kW can be installed with intelligent submersible pump system - realizing intelligent operation and health management of pumps. Intelligent submersible pump system can save 40-60% of operation and maintenance labor investment than traditional pumps. Intelligent submersible pump system can effectively reduce the number of equipment spare parts by more than 40% through the potential failure warning. Intelligent submersible pump system can save more than 30% of equipment energy consumption by optimizing the operating condition parameters.

叶轮说明 Impeller description

叶片式叶轮 Vane Impeller

- 水力采用CFD技术优化，效率高，高效区宽
- 先进的铸造工艺，精工铸造
- 流道宽阔，污物通过性好
- 用于输送含颗粒及较短纤维的污物（泥）介质
- Hydraulic design optimized with CFD technology for high efficiency and wide operational range.
- Adopts advanced casting technology with precision manufacturing.
- The flow channel is wide and solids passage capability is good.
- It is suitable for conveying dirt(mud) containing particles and shorter fibers.



流道式叶轮(C) Channel Impeller (Type C)

- 水力采用CFD技术优化，兼顾效率及污物通过能力
- 所有叶轮均经过动、静平衡校正，振动小，噪音低，运转平稳，寿命长
- 采用无堵塞理论设计的叶轮，流道宽阔，污物容易通过
- 用于输送含颗粒及较长纤维的污物（泥）介质
- Hydraulic design optimized with CFD technology, taking into account both efficiency and solids passage capability.
- All impellers have undergone dynamic and static balance correction. Low vibration, low noise, smooth operation and long service life.
- The impeller designed with the non-clogging theory has a wide flow channel, making it easy for dirt to pass through.
- It is suitable for conveying dirt (mud) containing particles and longer fibers.



螺旋式叶轮(S) Helical Impeller (Type S)

- 水力采用CFD技术优化，兼顾效率及污物通过能力
- 叶轮可旋入软质固体防吸口堵塞，背部反向螺纹槽还能防纤维积聚
- 适用于输送含大体积固体与长纤维介质
- 具备柔和输送优点：活性污泥/松散物料不破碎撕裂，悬浮纤维不缠绕绞结，西红柿、活鱼等易碎品不受损，乳液油品保持稳定
- Hydraulic design optimized with CFD technology, taking into account both efficiency and solids passage capability.
- The impeller can draw in soft solids to prevent suction port clogging, and the reverse thread grooves on its back can further avoid fiber accumulation.
- It is suitable for conveying media containing large-volume solids and long fibers.
- It boasts the advantage of gentle conveying: activated sludge and loose materials will not be crushed or torn; suspended fibers will not get tangled or knotted; fragile items such as tomatoes and live fish will remain intact; and emulsions and oils can maintain stable properties.



型号说明 Type description



QW/QW(C)7.5kW(含)以下结构简图 Construction

NO.	名称	Name	材质	
			GB	JIS
1	动力电缆	Power cable	NBR	NBR
2	电缆压盖	Cable cover	06Cr19Ni10	SUS304
3	波形弹簧	Wave spring	65Mn	65Mn
4	电木板	Electric board	-	-
5	马达本体	Motor casing	HT200	FC200
6	挡圈	Retaining ring	65Mn	65Mn
7	中承座	Bracket	HT200	FC200
8	O型圈	O-ring	NBR	NBR
9	油箱盖	Oil cover	HT200	FC200
10	叶轮	Impeller	HT200	FC200
11	泵体	Pump casing	HT200	FC200
12	垫圈	Washer	20Cr13	SUS420JI
13	螺栓	Bolt	06Cr19Ni10	SUS304
14	密封环	Seal ring	ZCuSn10Pb5	LBC2

NO.	名称	Name	材质	
			GB	JIS
15	把手	Handle	06Cr19Ni10	SUS304
16	马达盖	Motor cover	HT200	FC200
17	轴承	Bearing	-	-
18	转子	Rotor	-	-
19	定子	Stator	-	-
20	主轴	Shaft	20Cr13	SUS420JI
21	机械密封	Mechanical seal	C-SiC	C-SiC
22	机械密封	Mechanical seal	SiC-SiC	SiC-SiC
23	键	Key	20Cr13	SUS420JI
24	固定架	Fixed frame	Q235A	SS400
25	引导管	Pail piping	06Cr19Ni10	SUS304
26	配合凸缘	Flange setter	HT200	FC200
27	着脱本体	Duckfoot	HT200	FC200

不同机型结构略有不同，可根据需求采用不同材质。

Different model has a little difference, materials can be selected according to the requirement of the customer.

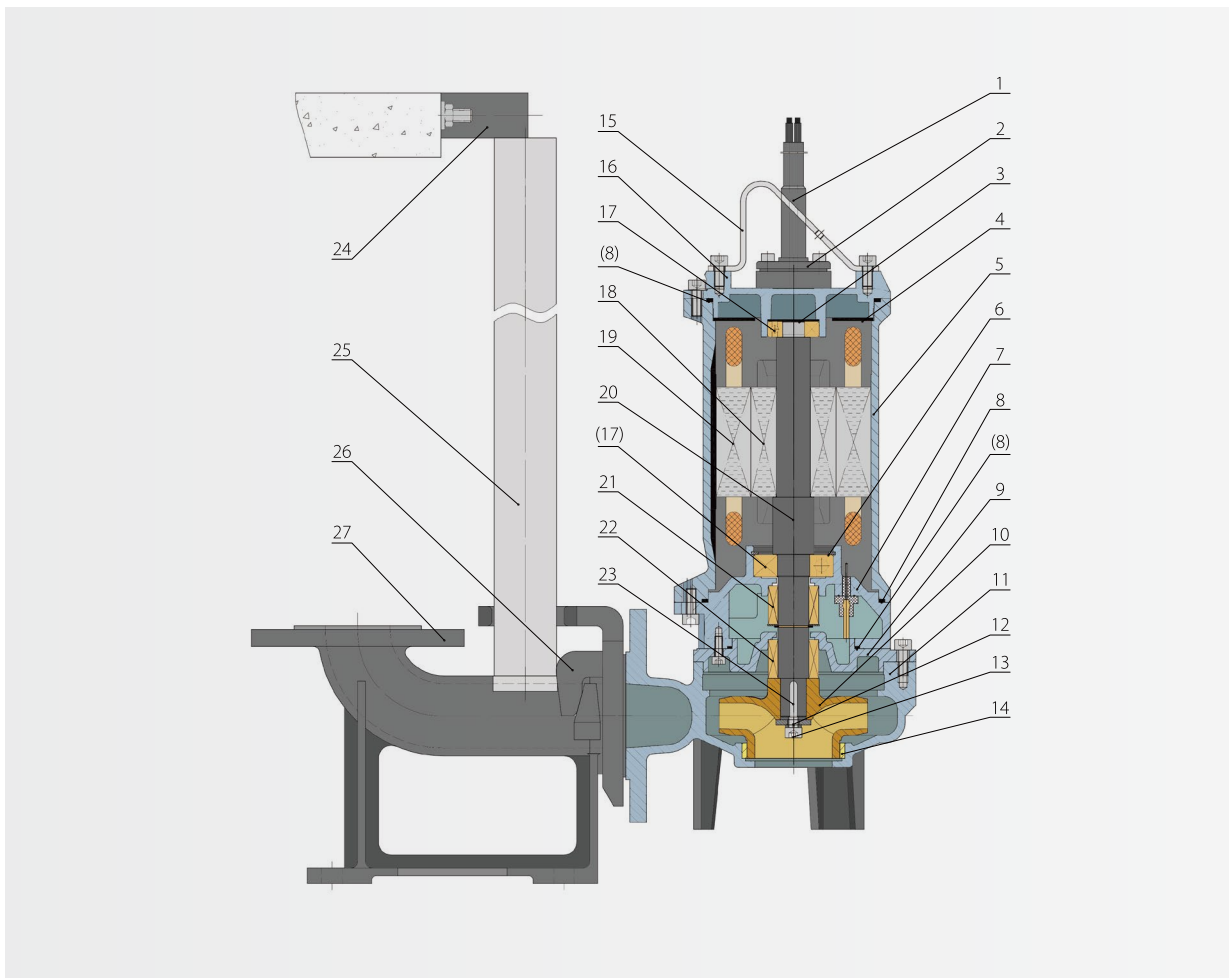

QW/QW(C)11kW(含)以上结构简图 Construction

NO.	名称	Name	材质	
			GB	Material JIS
1	动力电缆	Power cable	NBR	NBR
2	电缆压盖	Cable cover	HT200	FC200
3	电缆固定套	Cable fixing sleeves	HT200	FC200
4	O型圈	O-ring	NBR	NBR
5	接线盒	Junction box	HT200	FC200
6	轴承	Bearing	-	-
7	马达本体	Motor casing	HT200	FC200
8	轴承压盖	Bearing cover	HT200	FC200
9	中承座	Bracket	HT200	FC200
10	机械密封	Mechanical seal	SiC-SiC	SiC-SiC
11	油箱盖	Oil cover	HT200	FC200
12	叶轮	Impeller	HT200	FC200
13	泵体	Pump casing	HT200	FC200
14	密封环	Seal ring	ZCuSn10Pb5	LBC2
15	泵体底盖	Bottom cover	HT200	FC200
16	提升架	Lifting frame	06Cr19Ni10	SUS304
17	控制电缆	Control cable	NBR	NBR

NO.	名称	Name	材质	
			GB	Material JIS
18	电缆压盖	Cable cover	06Cr19Ni10	SUS304
19	马达盖	Motor cover	HT200	FC200
20	接线柱	Terminal block	-	-
21	主轴	Shaft	20Cr13	SUS420J1
22	转子	Rotor	-	-
23	定子	Stator	-	-
24	圆螺母	Round nut	45	S45C
25	机械密封	Mechanical seal	C-SiC	C-SiC
26	键	Key	20Cr13	SUS420J1
27	垫圈	Washer	06Cr19Ni10	SUS304
28	叶轮螺母	Impeller nut	06Cr19Ni10	SUS304
29	固定架	Fixed frame	Q235A	SS400
30	引导管	Pail piping	06Cr19Ni10	SUS304
31	引导板	Slide	HT200	FC200
32	配合凸缘	Flange setter	HT200	FC200
33	着脱本体	Duckfoot	HT200	FC200

不同机型结构略有不同，可根据需求采用不同材质。

Different model has a little difference, materials can be selected according to the requirement of the customer.

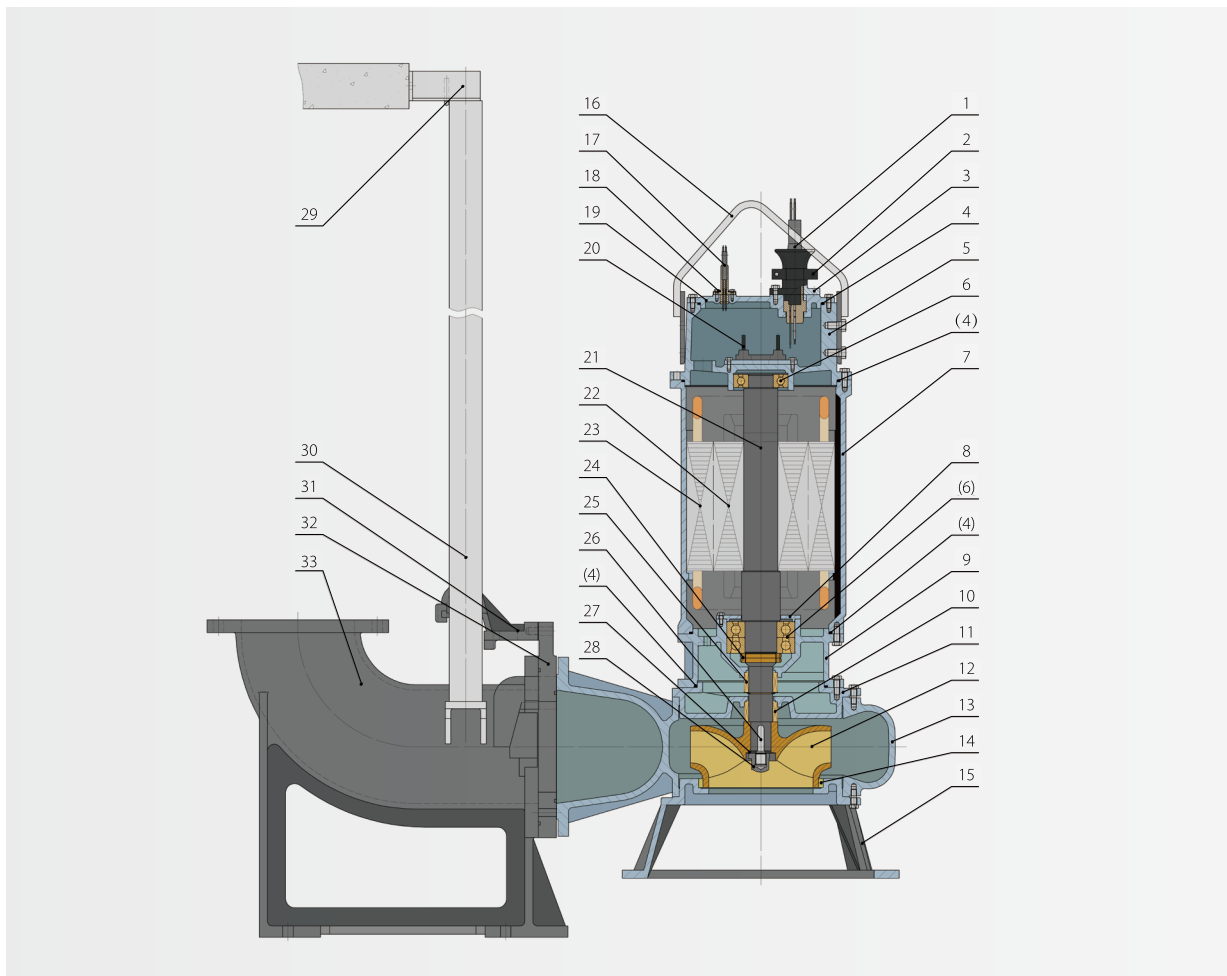

QW(S)结构简图 Construction

NO.	名称	Name	材质	
			GB	Material JIS
1	动力电缆	Power cable	NBR	NBR
2	电缆压盖	Cable cover	06Cr19Ni10	SUS304
3	波形弹簧	Wave spring	65Mn	65Mn
4	电木板	Electric board	-	-
5	马达本体	Motor casing	HT200	FC200
6	挡圈	Retaining ring	65Mn	65Mn
7	中承座	Bracket	HT200	FC200
8	O型圈	O-ring	NBR	NBR
9	油箱盖	Oil cover	HT200	FC200
10	密封盘	Sealing disc	HT200	FC200
11	泵体	Pump casing	HT200	FC200
12	垫圈	Washer	20Cr13	SUS420J1
13	螺栓	Bolt	06Cr19Ni10	SUS304
14	叶轮	Impeller	42CrMo	SCM440

NO.	名称	Name	材质	
			GB	Material JIS
15	密封环	Seal ring	HT200	FC200
16	把手	Handle	06Cr19Ni10	SUS304
17	马达盖	Motor cover	HT200	FC200
18	轴承	Bearing	-	-
19	转子	Rotor	-	-
20	定子	Stator	-	-
21	主轴	Shaft	20Cr13	SUS420J1
22	机械密封	Mechanical seal	C-SiC	C-SiC
23	机械密封	Mechanical seal	SiC-SiC	Sic-sic
24	固定架	Fixed frame	Q235A	SS400
25	引导管	Pail piping	06Cr19Ni10	SUS304
26	配合凸缘	Flange setter	HT200	FC200
27	着脱本体	Duckfoot	HT200	FC200

不同机型结构略有不同，可根据需求采用不同材质。

Different model has a little difference, materials can be selected according to the requirement of the customer.

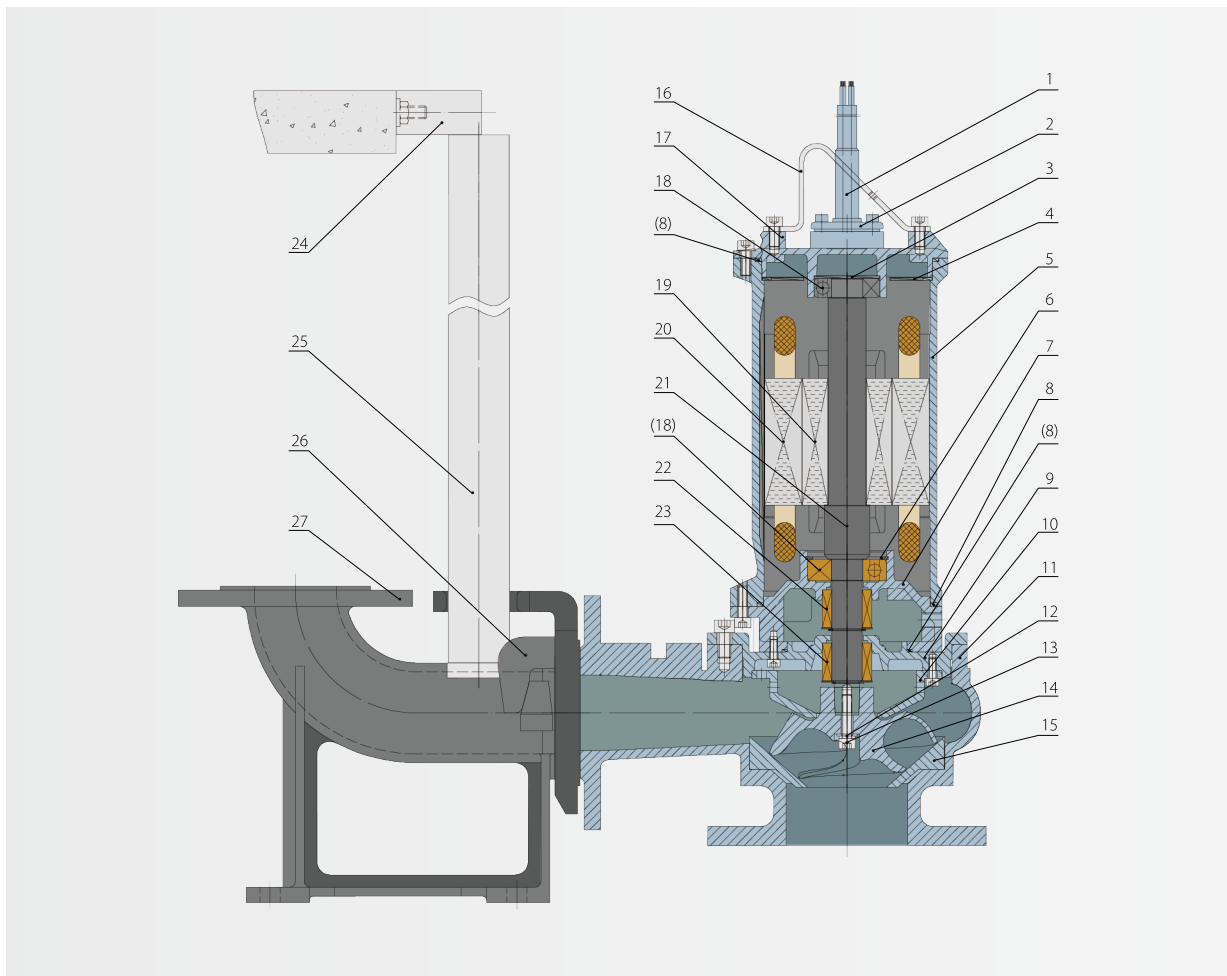

智能潜污泵结构图 Intelligent submersible pump structure

GSD3智能数据采集器 GSD3 Intelligent Data Collector



将数据采集器外置安装于电控柜中。对内部监测项目信号进行收集打包传输，也可单独外接显示屏，现场直接显示水泵运转状态。

Externally mount the data collector in the electrical control cabinet. The internal monitoring signals are collected, packaged and transmitted and can also be connected to a separate external display to directly show the running status of the pump.



绕组测温 Heat detector in stator

监控电机定子温度情况，防止电机温度过高。

Monitor the temperature of the motor stator to prevent the motor from overheating.



轴承测温 Heat detector in bearing

实现对轴承部位状态实时监测，故障预警，保护轴承及电机安全。

Real-time monitoring of bearing status and fault warning to protect bearing and motor safety.



电机内漏水保护 Leakage detector in motor

对电机腔内泄漏发出报警信号，对电机实施保护。

An alarm signal is sent to protect the motor if there is a leak in the motor cavity.

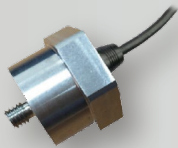

振动（选配） Vibration detector (Optional)

使用振动规实时振动指标的监测，提供设备运行状态和专家诊断的专业数据。

Use vibration gauges to monitor vibration indicators in real time, providing equipment operating status and diagnostic professional data.

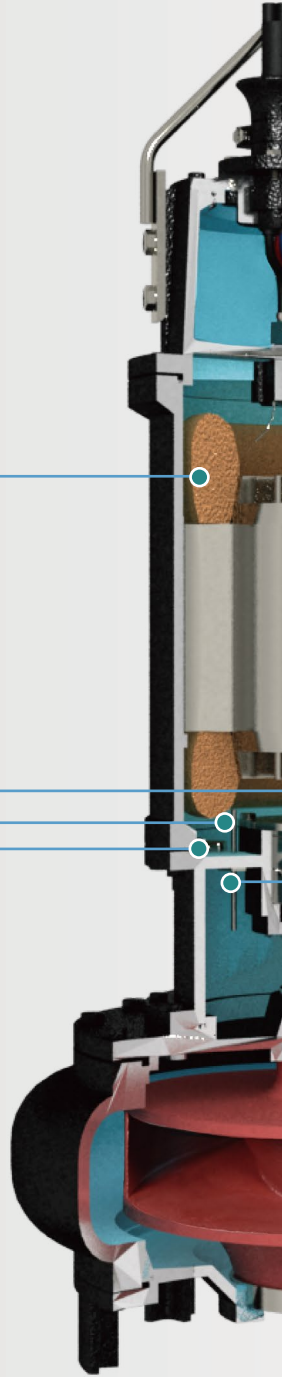

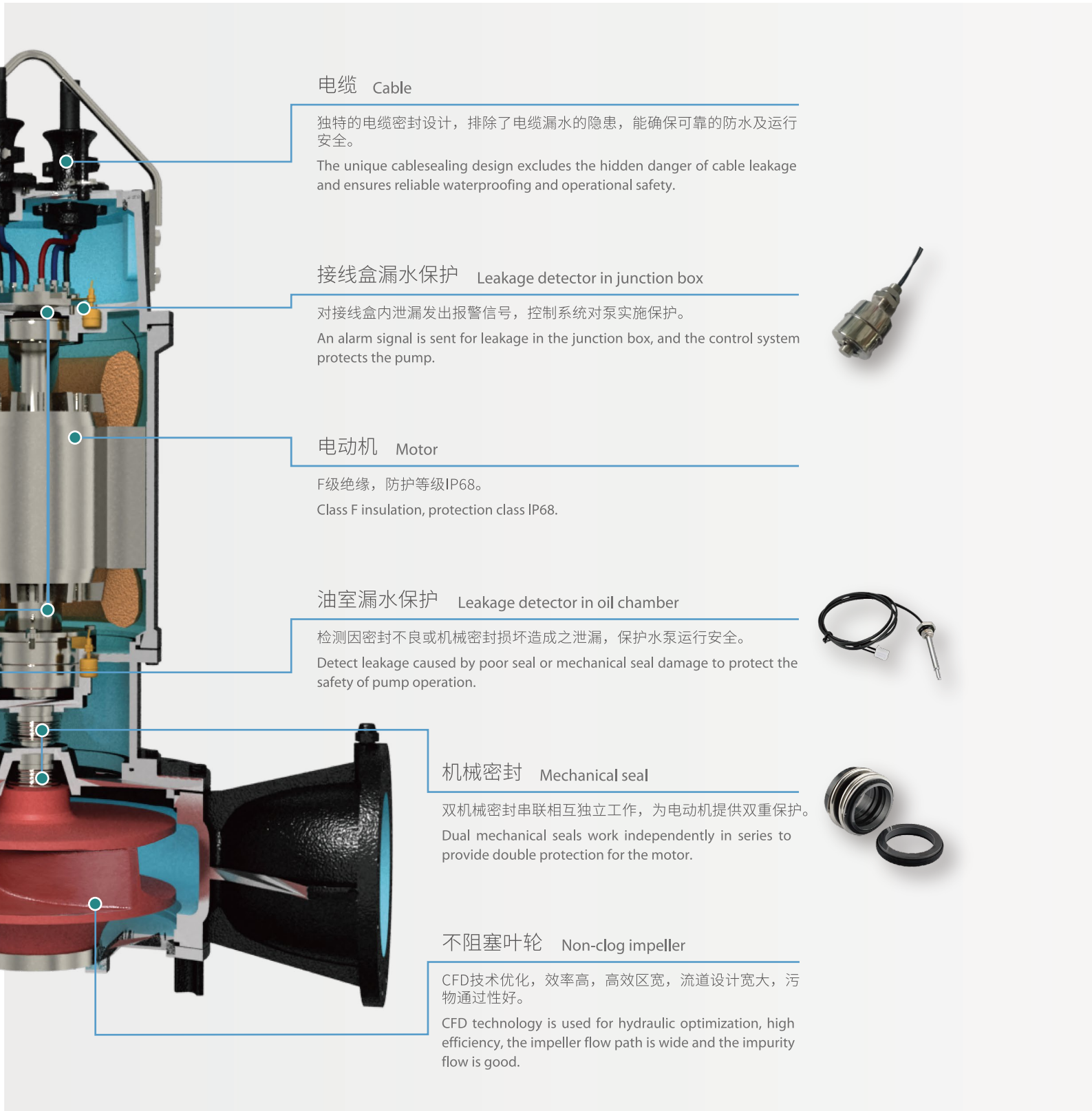

电缆 Cable

独特的电缆密封设计，排除了电缆漏水的隐患，能确保可靠的防水及运行安全。

The unique cablesealing design excludes the hidden danger of cable leakage and ensures reliable waterproofing and operational safety.

接线盒漏水保护 Leakage detector in junction box

对接线盒内泄漏发出报警信号，控制系统对泵实施保护。

An alarm signal is sent for leakage in the junction box, and the control system protects the pump.

电动机 Motor

F级绝缘，防护等级IP68。

Class F insulation, protection class IP68.

油室漏水保护 Leakage detector in oil chamber

检测因密封不良或机械密封损坏造成之泄漏，保护水泵运行安全。

Detect leakage caused by poor seal or mechanical seal damage to protect the safety of pump operation.

机械密封 Mechanical seal

双机械密封串联相互独立工作，为电动机提供双重保护。

Dual mechanical seals work independently in series to provide double protection for the motor.

不阻塞叶轮 Non-clog impeller

CFD技术优化，效率高，高效区宽，流道设计宽大，污物通过性好。

CFD technology is used for hydraulic optimization, high efficiency, the impeller flow path is wide and the impurity flow is good.

系统架构 System architecture

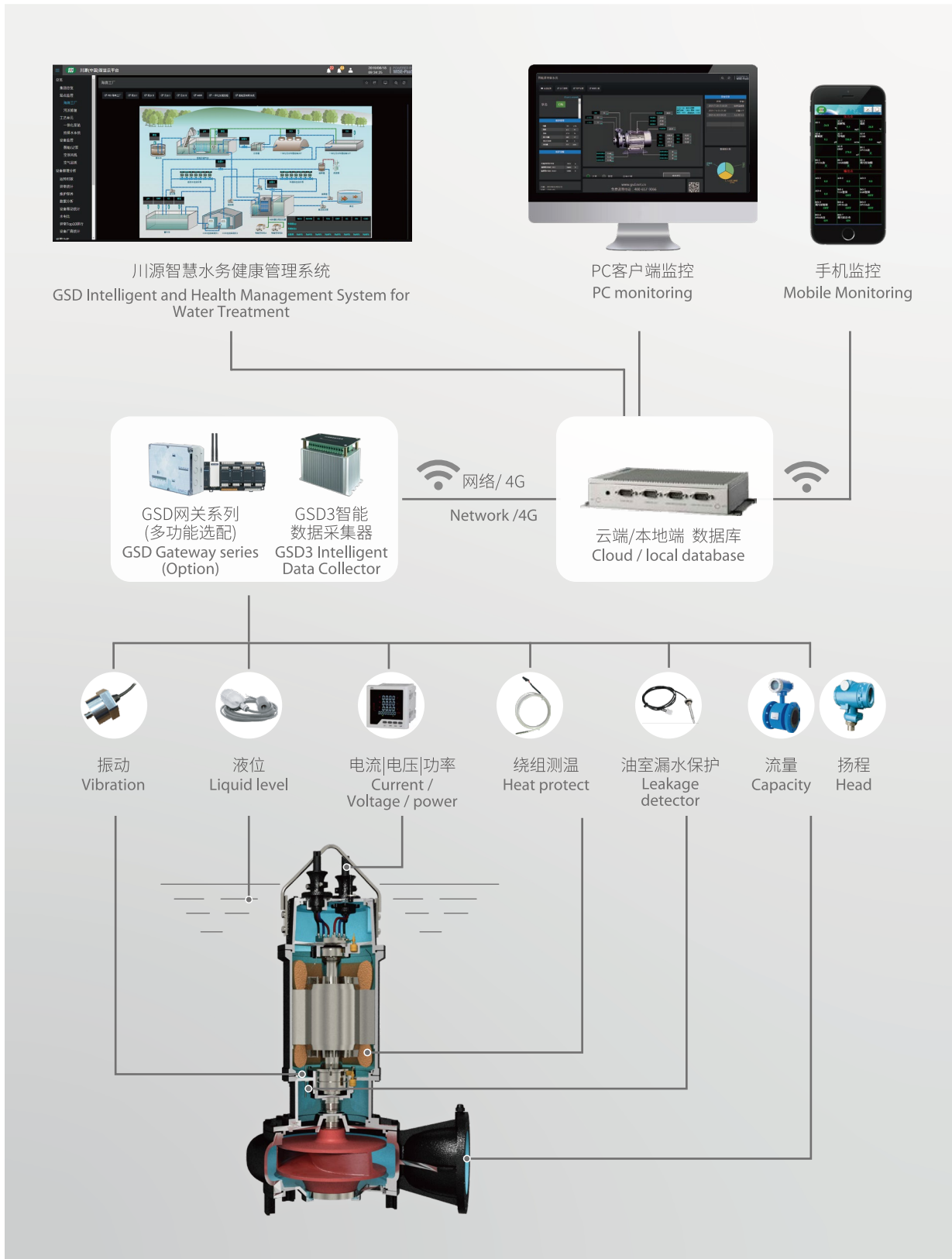

型谱图 Performance chart

QW

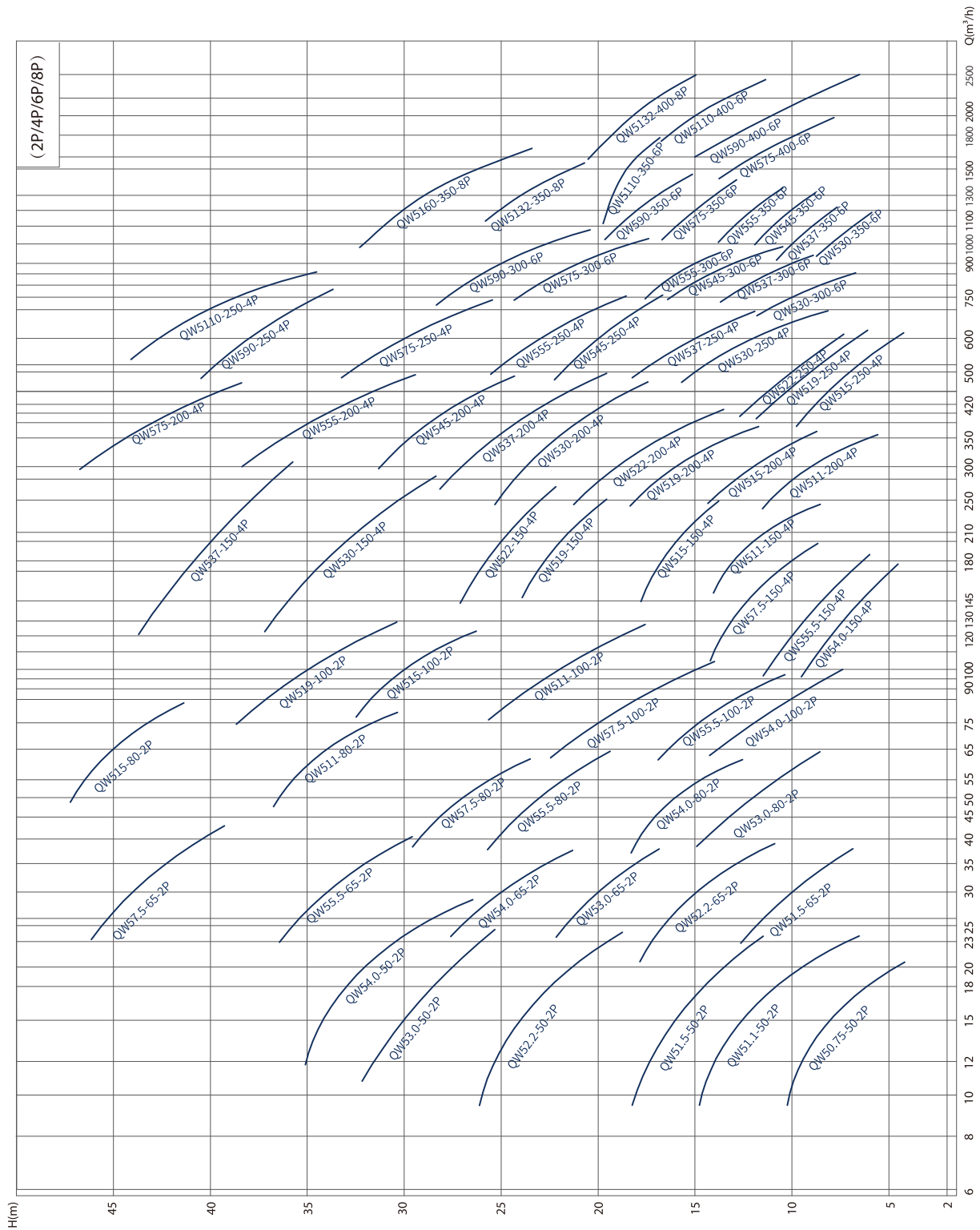

型谱图 Performance chart

QW (C)

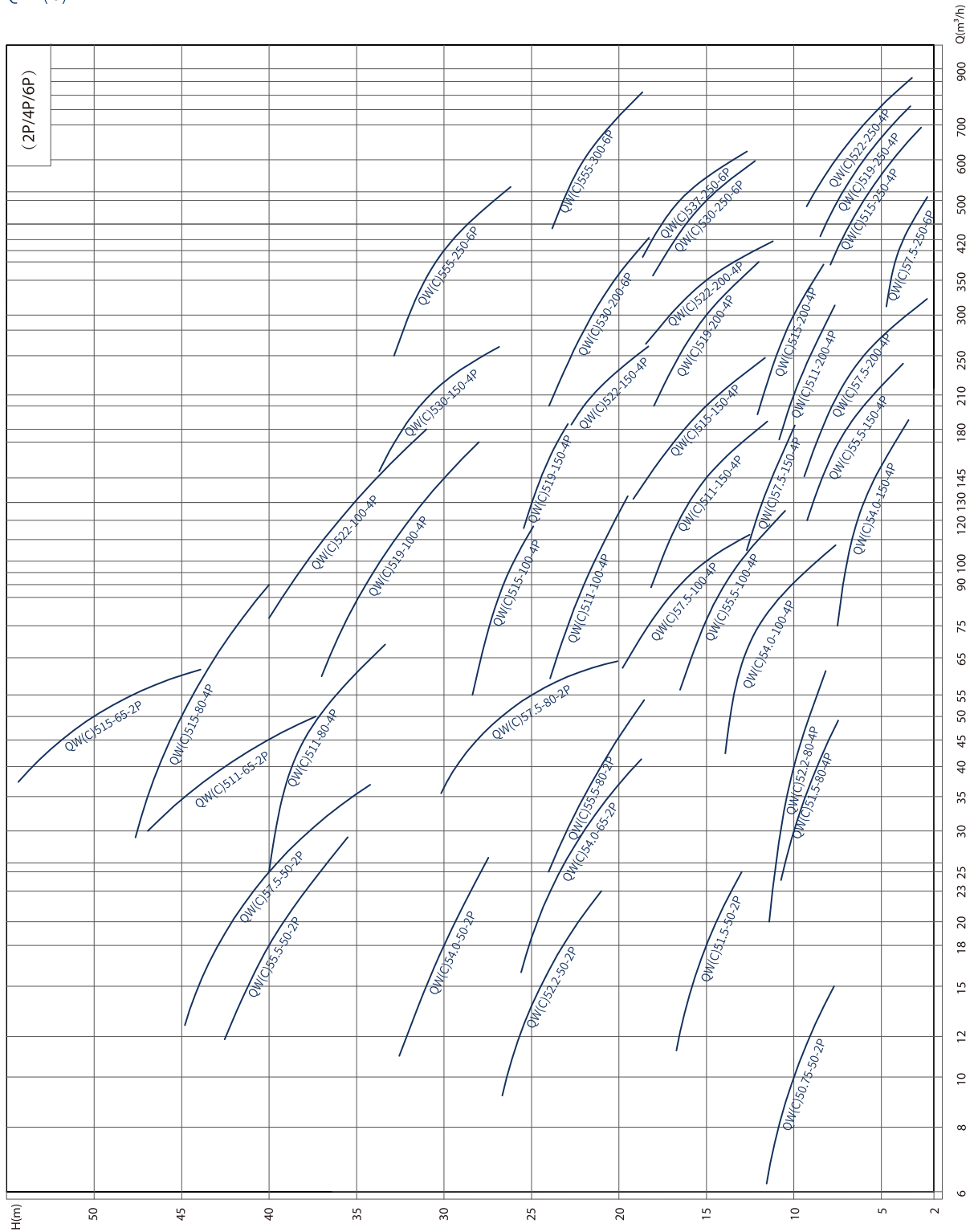

型谱图 Performance chart

QW (S)

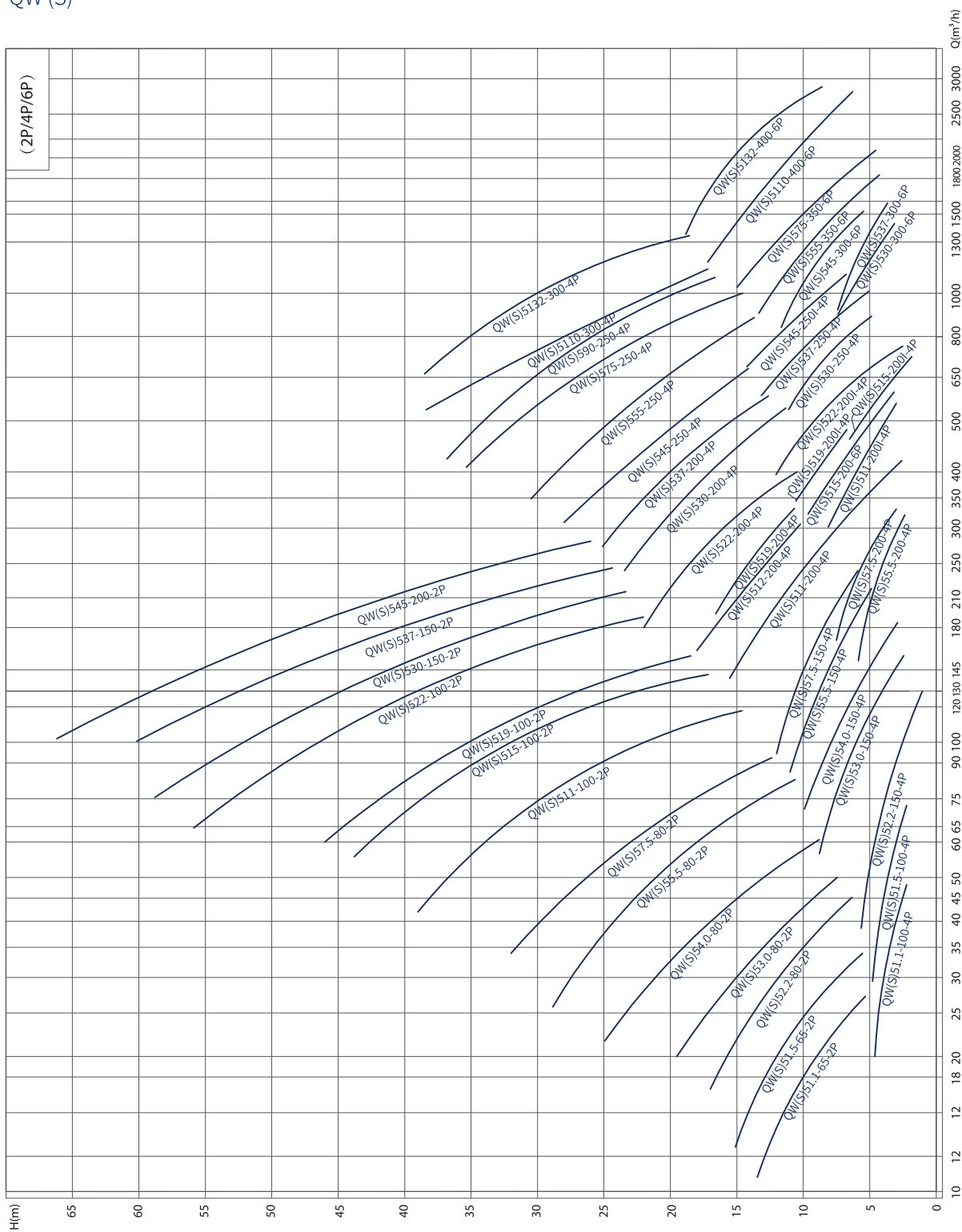

性能参数 Performance parameters

叶片式叶轮 Vane impeller

(2P/4P/6P/8P)

泵型号 Pump model	行业型号 Industry model	转速 Speed (r/min)	流量 Capacity (m ³ /h)	扬程 Head (m)	效率 Eff. η (%)	电机功率 Motor power (kW)	口径 Dia. (mm)	泵重量 Weight (kg)
QW50.75-50-2P	50QW15-8-0.75	2900	15	8	58	0.75	50	26.5
QW51.1-50-2P	50QW15-12.5-1.1	2900	15	12.5	60	1.1	50	26.5
QW51.5-50-2P	50QW15-16-1.5	2900	15	16	55	1.5	50	33
QW52.2-50-2P	50QW15-24-2.2	2900	15	24	54	2.2	50	38
QW53.0-50-2P	50QW15-30-3.0	2900	15	30	54	3.0	50	50
QW54.0-50-2P	50QW20-32-4.0	2900	20	32	56	4.0	50	50
QW51.5-65-2P	65QW30-10-1.5	2900	30	10	62	1.5	65	36
QW52.2-65-2P	65QW30-15-2.2	2900	30	15	64	2.2	65	36
QW53.0-65-2P	65QW30-20-3.0	2900	30	20	60	3.0	65	50
QW54.0-65-2P	65QW30-25-4.0	2900	30	25	62	4.0	65	50
QW55.5-65-2P	65QW30-34-5.5	2900	30	34	58	5.5	65	71
QW57.5-65-2P	65QW30-44-7.5	2900	30	44	58	7.5	65	73
QW53.0-80-2P	80QW50-12-3.0	2900	50	12	65	3.0	80	50
QW54.0-80-2P	80QW50-16-4.0	2900	50	16	67	4.0	80	52.6
QW55.5-80-2P	80QW50-23-5.5	2900	50	23	63	5.5	80	68
QW57.5-80-2P	80QW50-27-7.5	2900	50	27	66	7.5	80	72
QW511-80-2P	80QW65-34-11	2900	65	34	65	11	80	165
QW515-80-2P	80QW65-45-15	2900	65	45	66	15	80	170
QW54.0-100-2P	100QW80-11-4.0	2900	80	11	67	4.0	100	56
QW55.5-100-2P	100QW80-14-5.5	2900	80	14	68	5.5	100	70
QW57.5-100-2P	100QW80-19-7.5	2900	80	19	69	7.5	100	75
QW511-100-2P	100QW100-22-11	2900	100	22	66	11	100	200
QW515-100-2P	100QW100-30-15	2900	100	30	67	15	100	220
QW519-100-2P	100QW100-35-18.5	2900	100	35	68	18.5	100	238
QW54.0-150-4P	150QW120-8-4.0	1450	120	8	72	4.0	150	93
QW55.5-150-4P	150QW120-10-5.5	1450	120	10	73	5.5	150	113
QW57.5-150-4P	150QW120-12-7.5	1450	150	12	74	7.5	150	124
QW511-150-4P	150QW200-12-11	1450	200	12	70	11	150	260
QW515-150-4P	150QW200-16-15	1450	200	16	70	15	150	270
QW519-150-4P	150QW200-22-18.5	1450	200	22	74	18.5	150	295
QW522-150-4P	150QW200-25-22	1450	200	25	70	22	150	303
QW530-150-4P	150QW200-33-30	1450	200	33	71	30	150	430
QW537-150-4P	150QW200-40-37	1450	200	40	72	37	150	469
QW511-200-4P	200QW300-9-11	1450	300	9	73	11	200	260
QW515-200-4P	200QW300-12-15	1450	300	12	74	15	200	280
QW519-200-4P	200QW300-16-18.5	1450	300	16	76	18.5	200	300
QW522-200-4P	200QW300-19-22	1450	300	19	75	22	200	320
QW530-200-4P	200QW360-22-30	1450	360	22	76	30	200	460
QW537-200-4P	200QW360-25-37	1450	360	25	77	37	200	480
QW545-200-4P	200QW400-28-45	1450	400	28	74	45	200	680
QW555-200-4P	200QW400-34-55	1450	400	34	75	55	200	740
QW575-200-4P	200QW400-42-75	1450	400	42	76	75	200	790
QW515-250-4P	250QW500-7-15	1450	500	7	74	15	250	300
QW519-250-4P	250QW500-9-18.5	1450	500	9	74	18.5	250	330
QW522-250-4P	250QW500-10-22	1450	500	10	75	22	250	365
QW530-250-4P	250QW600-12-30	1450	600	12	76	30	250	480



叶片式叶轮 Vane impeller

(2P/4P/6P/8P)

泵型号 Pump model	行业型号 Industry model	转速 Speed (r/min)	流量 Capacity (m ³ /h)	扬程 Head (m)	效率 Eff. η ₁ (%)	电机功率 Motor power (kW)	口径 Dia. (mm)	泵重量 Weight (kg)
QW537-250-4P	250QW600-15-37	1450	600	15	77	37	250	520
QW545-250-4P	250QW600-20-45	1450	600	20	78	45	250	550
QW555-250-4P	250QW600-23-55	1450	600	23	75	55	250	800
QW575-250-4P	250QW600-30-75	1450	600	30	76	75	250	850
QW590-250-4P	250QW600-38-90	1450	600	38	78	90	250	900
QW5110-250-4P	250QW700-40-110	1450	700	40	78	110	250	900
QW530-300-6P	300QW750-10-30	980	750	10	75	30	300	730
QW537-300-6P	300QW900-10-37	980	900	10	76	37	300	780
QW545-300-6P	300QW900-13-45	980	900	13	77	45	300	830
QW555-300-6P	300QW900-15-55	980	900	15	76	55	300	1000
QW575-300-6P	300QW900-21-75	980	900	21	77	75	300	1420
QW590-300-6P	300QW900-25-90	980	900	25	79	90	300	1455
QW530-350-6P	350QW1000-8-30	980	1000	8	79	30	350	760
QW537-350-6P	350QW1000-10-37	980	1000	10	81	37	350	850
QW545-350-6P	350QW1100-11-45	980	1100	11	83	45	350	1000
QW555-350-6P	350QW1100-13-55	980	1100	13	77	55	350	1180
QW575-350-6P	350QW1200-15-75	980	1200	15	78	75	350	1400
QW590-350-6P	350QW1200-18-90	980	1200	18	79	90	350	1470
QW5110-350-6P	350QW1300-19-110	980	1300	19	79	110	350	1500
QW5132-350-8P	350QW1300-24-132	740	1300	24	80	132	350	1990
QW5160-350-8P	350QW1300-30-160	740	1300	29	80	160	350	2115
QW575-400-6P	400QW1600-12-75	980	1600	12	77	75	400	1690
QW590-400-6P	400QW1800-13-90	980	1800	13	78	90	400	1740
QW5110-400-6P	400QW2000-15-110	980	2000	15	79	110	400	1900
QW5132-400-8P	400QW2200-17-132	740	2200	17	80	132	400	2010

流道式叶轮 Channel impeller

(2P/4P/6P)

泵型号 Pump model	行业型号 Industry model	转速 Speed (r/min)	流量 Capacity (m ³ /h)	扬程 Head (m)	效率 Eff. η ₁ (%)	电机功率 Motor power (kW)	口径 Dia. (mm)	泵重量 Weight (kg)
QW(C)50.75-50-2P	50QW10-10-0.75	2900	10	10	48	0.75	50	22.5
QW(C)51.5-50-2P	50QW18-15-1.5	2900	18	15	60	1.5	50	28
QW(C)52.2-50-2P	50QW15-24.5-2.2	2900	15	24.5	56	2.2	50	36
QW(C)54.0-50-2P	50QW18-30-4	2900	18	30	50	4	50	56
QW(C)55.5-50-2P	50QW18-40-5.5	2900	18	40	50	5.5	50	68
QW(C)57.5-50-2P	50QW25-40-7.5	2900	25	40	55	7.5	50	114
QW(C)54.0-65-2P	65QW30-22-4	2900	30	22	62	4	65	54
QW(C)511-65-2P	65QW45-40-11	2900	45	40	60	11	65	192
QW(C)515-65-2P	65QW50-50-15	2900	50	50	55	15	65	206
QW(C)51.5-80-4P	80QW30-10-1.5	1450	30	10	60	1.5	80	48
QW(C)52.2-80-4P	80QW40-10-2.2	1450	40	10	55	2.2	80	57
QW(C)55.5-80-2P	80QW35-22-5.5	2900	35	22	55	5.5	80	66
QW(C)57.5-80-2P	80QW55-25-7.5	2900	55	25	56	7.5	80	100
QW(C)511-80-4P	80QW45-38-11	1450	45	38	56	11	80	300
QW(C)515-80-4P	80QW50-45-15	1450	50	45	55	15	80	324
QW(C)54.0-100-4P	100QW75-12-4	1450	75	12	70	4	100	81



流道式叶轮 Channel impeller

(2P/4P/6P)

泵型号 Pump model	行业型号 Industry model	转速 Speed (r/min)	流量 Capacity (m ³ /h)	扬程 Head (m)	效率 Eff. η (%)	电机功率 Motor power (kW)	口径 Dia. (mm)	泵重量 Weight (kg)
QW(C)55.5-100-4P	100QW95-13.5-5.5	1450	95	13.5	73	5.5	100	116
QW(C)57.5-100-4P	100QW100-15-7.5	1450	100	15	65	7.5	100	134
QW(C)511-100-4P	100QW90-22-11	1450	90	22	62	11	100	238
QW(C)515-100-4P	100QW100-26-15	1450	100	26	65	15	100	265
QW(C)519-100-4P	100QW120-32-18.5	1450	120	32	64	18.5	100	320
QW(C)522-100-4P	100QW120-36-22	1450	120	36	65	22	100	340
QW(C)54.0-150-4P	150QW130-6-4	1450	130	6	66	4	150	100
QW(C)55.5-150-4P	150QW180-7-5.5	1450	180	7	73	5.5	150	122
QW(C)57.5-150-4P	150QW120-12-7.5	1450	120	12	70	7.5	150	132
QW(C)511-150-4P	150QW145-15-11	1450	145	15	65	11	150	257
QW(C)515-150-4P	150QW200-15-15	1450	200	15	74	15	150	265
QW(C)519-150-4P	150QW170-23.5-18.5	1450	170	23.5	73	18.5	150	348
QW(C)522-150-4P	150QW200-22-22	1450	200	22	71	22	150	359
QW(C)530-150-4P	150QW220-30-30	1450	220	30	75	30	150	445
QW(C)57.5-200-4P	200QW250-6-7.5	1450	250	6	67	7.5	200	148
QW(C)511-200-4P	200QW210-10-11	1450	210	10	65	11	200	289
QW(C)515-200-4P	200QW300-10-15	1450	300	10	68	15	200	301
QW(C)519-200-4P	200QW300-15-18.5	1450	300	15	75	18.5	200	450
QW(C)522-200-4P	200QW350-15-22	1450	350	15	72	22	200	452
QW(C)530-200-6P	200QW360-20-30	980	360	20	76	30	200	631
QW(C)57.5-250-6P	250QW400-4-7.5	980	400	4	62	7.5	250	300
QW(C)515-250-4P	250QW500-6-15	1450	500	6	71	15	250	365
QW(C)519-250-4P	250QW600-6-18.5	1450	600	6	71	18.5	250	400
QW(C)522-250-4P	250QW700-6-22	1450	700	6	73	22	250	415
QW(C)530-250-6P	250QW500-15-30	980	500	15	75	30	250	700
QW(C)537-250-6P	250QW500-16.5-37	980	500	16.5	77	37	250	810
QW(C)555-250-6P	250QW400-30-55	980	400	30	72	55	250	1090
QW(C)555-300-6P	300QW600-22-55	980	600	22	75	55	300	1160

螺旋式叶轮 Helical impeller

(2P/4P/6P)

泵型号 Pump model	行业型号 Industry model	转速 Speed (r/min)	流量 Capacity (m ³ /h)	扬程 Head (m)	效率 Eff. η (%)	电机功率 Motor power (kW)	叶轮型式 Impeller type	口径 Dia. (mm)	泵重量 Weight (kg)
QW(S)51.1-65-2P	65QW20-9-1.1	2900	20	9	53	1.1	D	65	42
QW(S)51.5-65-2P	65QW20-12-1.5	2900	20	12	54	1.5	D	65	45
QW(S)52.2-80-2P	80QW35-10-2.2	2900	35	10	52	2.2	D	80	58
QW(S)53.0-80-2P	80QW35-13-3	2900	35	13	53	3.0	D	80	60
QW(S)54.0-80-2P	80QW35-19-4	2900	35	19	55	4.0	D	80	80
QW(S)55.5-80-2P	80QW60-18-5.5	2900	60	18	56	5.5	D	80	110
QW(S)57.5-80-2P	80QW60-23-7.5	2900	60	23	54	7.5	D	80	115
QW(S)511-100-2P	100QW100-22-11	2900	100	22	60	11	D	100	175
QW(S)515-100-2P	100QW100-32-15	2900	100	32	63	15	D	100	180
QW(S)519-100-2P	100QW130-27-18.5	2900	130	27	61	18.5	D	100	350



螺旋式叶轮 Helical impeller

(2P/4P/6P)

泵型号 Pump model	行业型号 Industry model	转速 Speed (r/min)	流量 Capacity (m ³ /h)	扬程 Head (m)	效率 Eff. η (%)	电机功率 Motor power (kW)	叶轮型式 Impeller type	口径 Dia. (mm)	泵重量 Weight (kg)
QW(S)522-100-2P	100QW130-39-22	2900	130	39	65	22	D	100	360
QW(S)530-150-2P	150QW180-32-30	2900	180	32	60	30	D	150	530
QW(S)537-150-2P	150QW180-39-37	2900	180	39	61	37	D	150	535
QW(S)545-200-2P	200QW250-32-45	2900	250	32	60	45	D	200	600
QW(S)51.1-100-4P	100QW40-3-1.1	1450	40	3	40	1.1	Z	100	62
QW(S)51.5-100-4P	100QW60-3-1.5	1450	60	3	48	1.5	Z	100	65
QW(S)52.2-150-4P	150QW100-2.5-2.2	1450	100	2.5	41	2.2	Z	150	100
QW(S)53.0-150-4P	150QW100-6-3	1450	100	6	63	3.0	Z	150	105
QW(S)54.0-150-4P	150QW130-6-4	1450	130	6	64	4.0	Z	150	145
QW(S)55.5-150-4P	150QW180-6.5-5.5	1450	180	6.5	64	5.5	Z	150	170
QW(S)57.5-150-4P	150QW180-8.5-7.5	1450	180	8.5	60	7.5	Z	150	175
QW(S)511-200-4P	200QW300-7.5-11	1450	300	7.5	63	11	Z	200	298
QW(S)515-200-4P	200QW300-10.5-15	1450	300	10.5	67	15	Z	200	310
QW(S)515-200-6P	200QW400-7.5-15	980	400	7.5	63	15	Z	200	480
QW(S)519-200-4P	200QW300-12-18.5	1450	300	12	66	18.5	Z	200	420
QW(S)522-200-4P	200QW300-16-22	1450	300	16	62	22	Z	200	430
QW(S)530-200-4P	200QW400-17-30	1450	400	17	68	30	Z	200	670
QW(S)537-200-4P	200QW400-20-37	1450	400	20	67	37	Z	200	690
QW(S)545-250-4P	250QW650-15-45	1450	650	15	64	45	Z	250	730
QW(S)555-250-4P	250QW800-16-55	1450	800	16	72	55	Z	250	970
QW(S)575-250-4P	250QW800-22-75	1450	800	22	71	75	Z	250	1050
QW(S)590-250-4P	250QW800-26-90	1450	800	26	69	90	Z	250	1100
QW(S)545-300-6P	300QW1000-10.5-45	980	1000	10.5	73	45	Z	300	1050
QW(S)5110-300-4P	300QW900-26-110	1450	900	26	62	110	Z	300	1450
QW(S)5132-300-4P	300QW1100-26-132	1450	1100	26	64	132	Z	300	1580
QW(S)55.5-200-4P	200QW250-4-5.5	1450	250	4	51	5.5	H	200	200
QW(S)57.5-200-4P	200QW250-5.5-7.5	1450	250	5.5	51	7.5	H	200	205
QW(S)511-200I-4P	200QW400-6-11	1450	400	6	65	11	H	200	305
QW(S)515-200I-4P	200QW400-8-15	1450	400	8	69	15	H	200	315
QW(S)519-200I-4P	200QW400-9-18.5	1450	400	9	54	18.5	H	200	425
QW(S)522-200I-4P	200QW400-12-22	1450	400	12	60	22	H	200	440
QW(S)530-250-4P	250QW650-9.5-30	1450	650	9.5	61	30	H	250	650
QW(S)537-250-4P	250QW650-12-37	1450	650	12	61	37	H	250	670
QW(S)545-250I-4P	250QW800-12-45	1450	800	12	62	45	H	250	720
QW(S)530-300-6P	300QW1000-6.5-30	980	1000	6.5	65	30	H	300	940
QW(S)537-300-6P	300QW1000-7-37	980	1000	7	65	37	H	300	970
QW(S)555-350-6P	350QW1500-7.5-55	980	1500	7.5	70	55	H	350	1200
QW(S)575-350-6P	350QW1500-10-75	980	1500	10	66	75	H	350	1300
QW(S)5110-400-6P	400QW2000-11-110	980	2000	11	63	110	H	400	1840
QW(S)5132-400-6P	400QW2000-15.5-132	980	2000	15.5	71	132	H	400	1950



螺旋叶轮类型 Helical impeller type

叶轮形状 Shape of impeller	类型 Type	应用 Application	实例 Examples
	闭式叶轮 Closed Impeller D型叶轮, 闭阀启动 D-type impeller, valve closing start	柔和输送大块物质 Delicate handling of large-volume material	易损坏的物质, 如水果、蔬菜、活鱼 Delicate good, such as fruit, vegetables, fish
	中低压力叶轮 Medium and low - Pressure impeller Z型叶轮, 开阀启动 Z-type impeller, valve opening start	输送悬浮在介质中的 粗糙的颗粒 Handling of granulates Coarse solid suspensions	悬浮谷物、结晶体、碎片的介质, 如未经隔栅过滤的污水、 屠宰加工厂的废水 Cereal suspensions, crystals flakes, Media contaminated with Solid matter, such as unscreened sewage, abattoir wastes
	带可调内衬的 中压力叶轮 Medium pressure impeller with Adjustable suction Cones Z型叶轮, 开阀启动 Z-type impeller, valve opening start	纤维或易结物质 腐蚀性固体 Fibrous, knot-forming material Solid with abrasive characteristics	悬浮的纺织品、人造纤维 尼龙, 泥沙的雨水 Textile suspensions and artificial fibres, such as nylon Storm water containing dirt and sand
	带可调内衬的 高压力叶轮 High-pressure impeller with adjustable suction cones H型叶轮, 开阀启动 H-type impeller, valve opening start	粘稠、泥状和含气的液体 Viscous, sludgy and gaseous liquids	油漆、胶水、纸浆、沉淀污泥 以及能产生气体或能形成片状 物质的生物处理过程 Paint, glue, paper stock, sludge from sedimentation as well as gas-producing or flake-forming biological processes
	带可耐磨内衬的 高中压力叶轮 High and medium-Pressure impeller With adjustable wear liner H型叶轮, 开阀启动 H-type impeller, valve opening start	高磨蚀性介质 Strongly abrasive media	含砂砾较多的液及研磨废水 Liquids heavily contaminated with sand and gravel, as well as grinding and milling wastes

不同型式泵输送干固体含量的能力对比
Dry solids capacity of various pump types

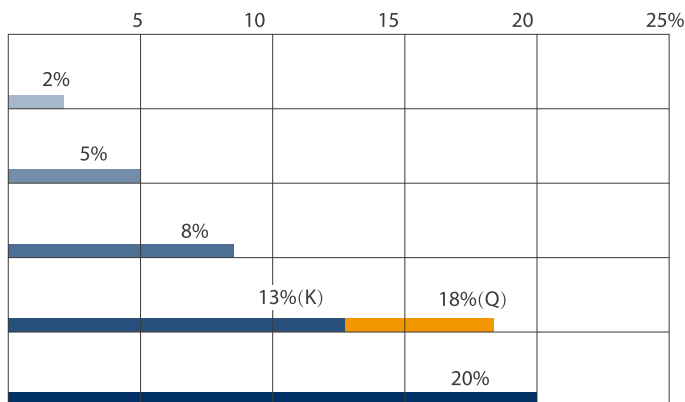

- 多叶片离心式
Multivane centrifugal
- 单或双叶片离心式
Single or double vane centrifugal
- 涡流式
Vortex
- 螺旋离心式
Screw centrifugal
- 阿基米德螺旋式, 渐进容积式
Archimedes screw, progressive cavity

安装示意图 Installation sketch map

未附着脱
without autosetter

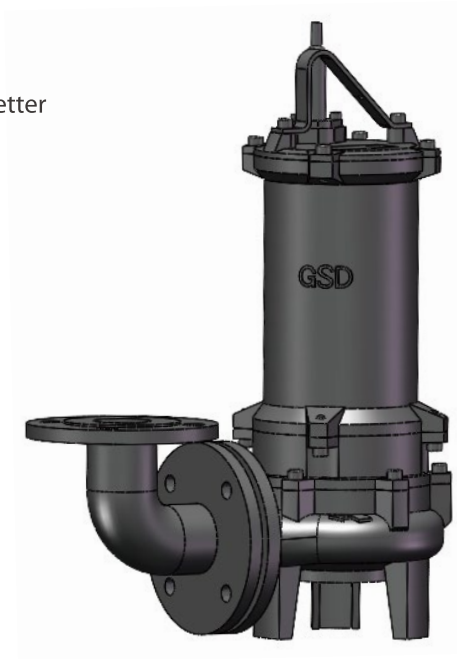

附着脱
with autosetter



欢迎索取以下产品型录

To find out more about following products, please visit www.gsd.net.cn

	泵系列 Pump Series	潜水泵系列 陆上泵系列 特种泵系列 Submersible pump series On land pump series Special pump series
	搅拌推流系列 Mixing and flow propeller	搅拌机系列 推流器系列 Mixing series Flow propeller series
	供氧曝气系列 Aeration equipment series	曝气机系列 曝气盘系列 曝气管系列 Aerator series Disc diffusers Tube diffusers
	风机系列 Blower Series	磁悬浮鼓风机 空气悬浮高速离心鼓风机 三叶罗茨鼓风机系列 Maglev turbo blower High-Speed centrifugal blower Three-lobe Roots Blower blower series
	污泥处理设备 Sludge treatment equipment	带式脱水机 厢式压滤机 叠螺式脱水机 污泥干化设备 浅层高效气浮设备 Belt filter press Box filter press Screw press Mud scraper Dissolved air flotation clarifier
	智能化系列 Intelligent series	智能设备 水务设备健康管理 水务系统工艺优化智能管理 Intelligent equipment Health management for water equipment Intelligent management for water system process
	反应器及套装设备 Reactor and package equipment	芬顿反应系统 MBR生物膜反应器 预制泵站 一体化污水处理设备 Fenton reaction system MBR biofilm reactor Prefabricated pumping station Intelligent Compact Unit
	耗材药剂及相关设备 Consumables, reagents and related equipment	生物绳 PAC 聚合氯化铝 PAM 聚丙烯酰胺 泡药设备 Biological rope PAC polyaluminum chloride PAM polyacrylamide Automatic dispensing dissolvers

GSD 的经营理念 Business Philosophy

G-Green 绿色 S-Safe 安全 D-Development 永续经营



川源(中国)机械有限公司
GSD (China) Co., Ltd.

水处理系统专业合作伙伴

Professional partners in water treatment systems

免费咨询电话

400-657-9066

川源(中国)机械有限公司版权所有 all rights reserved. CY-61

数据来源: 公司实验室数据及客户实际使用数据, 具体使用环境不同, 数据可能存在差异。本型录内容如有变更, 恕不另行通知。

The data on the brochure is based on the laboratory testing data and customers' actual operation data in the past. The actual data may be different in different application conditions. We reserve the right to change content without notice.

