



川源(中国)机械有限公司
GSD (China) Co., Ltd.



QY

沉水式污物(泥)泵

QY submersible solid handling pump

QY 沉水式污物(泥)泵

QY submersible solid handling pump



用途 Application

- 废水扬升站
 - 都市废水处理厂
 - 化粪池排水系统
 - 医院、学校、社区等生活废水处理系统
 - 食品、造纸、采矿、纺织、皮革、化学工厂等工业之废水处理系统
 - 净水处理系统
-
- Wastewater lift station.
 - Municipal wastewater treatment plant.
 - Building wastewater treatment system.
 - Hospital, school, community, etc. wastewater treatment system.
 - Food, paper, mining, textile, leather, chemical industry, etc. wastewater treatment system.
 - Water purification system.

特点 Features

- **电动机**
鼠笼式感应电动机，F级绝缘，防护等级IP68。
- **叶轮**
采用CFD技术设计，宽出水口，水流畅通，污物容易通过，效率高。
所有叶轮均经动、静平衡校正，能够减少振动和噪音，运转平稳，寿命长。
- **机械密封**
机械密封的作用是阻绝抽送介质与电动机部分接触，双端面机械密封加外置骨架油封，为电动机提供更好的保护。
- **自动着脱装置（选用配备）**
使泵浦安装、保养、修护迅速容易，毋须先清除桶槽污水。
- **测漏检知器（选用配备）**
在油室内加装测漏检知器，可检测因密封不良或机械密封损坏造成之洩漏。
- **过热保护器（选用配备）**
在电动机中加装过热保护器，对过载、温升等状况自动进行检测，避免由于电动机过热造成电机烧毁。

- **Motor**
Squirrel-cage, induction motors are F class insulation, motor protection grade is IP68.
- **Impeller**
The pump uses CFD technique for design, with wide inlet, which makes the stable flow, easier sewage passage and high efficiency. It adopts rigorous technics so that vibration and noise can be farthest reduced.
- **Mechanical seal**
The mechanical seals protect the motor from contacting the pumping liquids. Double mechanical seals with external skeleton oil seal, offering enhanced protection for the motor.
- **Auto-setter (options)**
To allow pump for easy installation, maintenance & reparation, as it is no need to empty the tank first.
- **Leakage detector (options)**
Built-in leakage detector in the oil chamber can detect leakage from the damage of the mechanical seal.
- **Heat-protector (options)**
Built-in heat protector in motor, can prevent the motor from burning out, overload & overheating.



型号说明 Type description

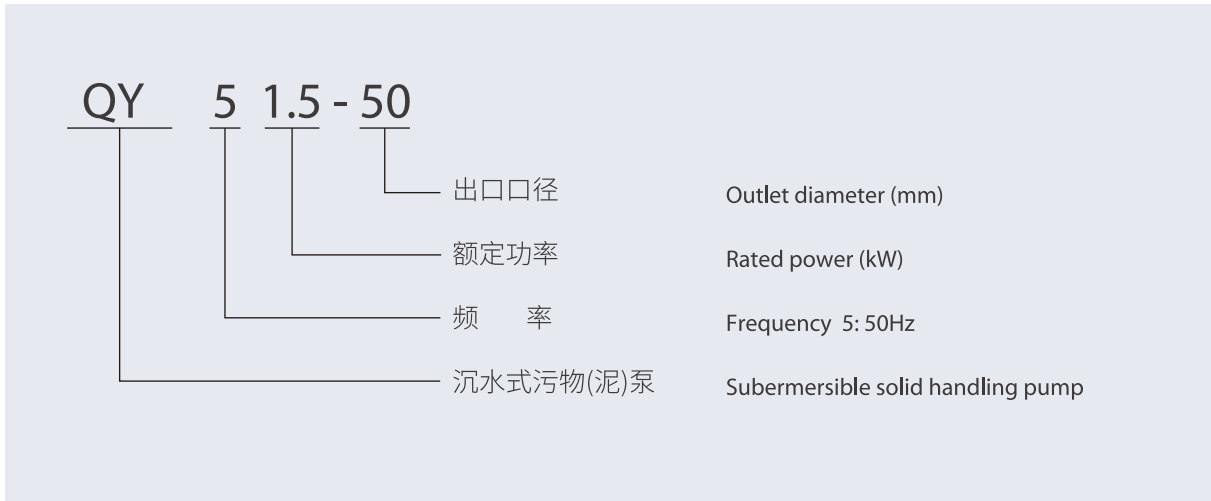

型谱图 Performance chart

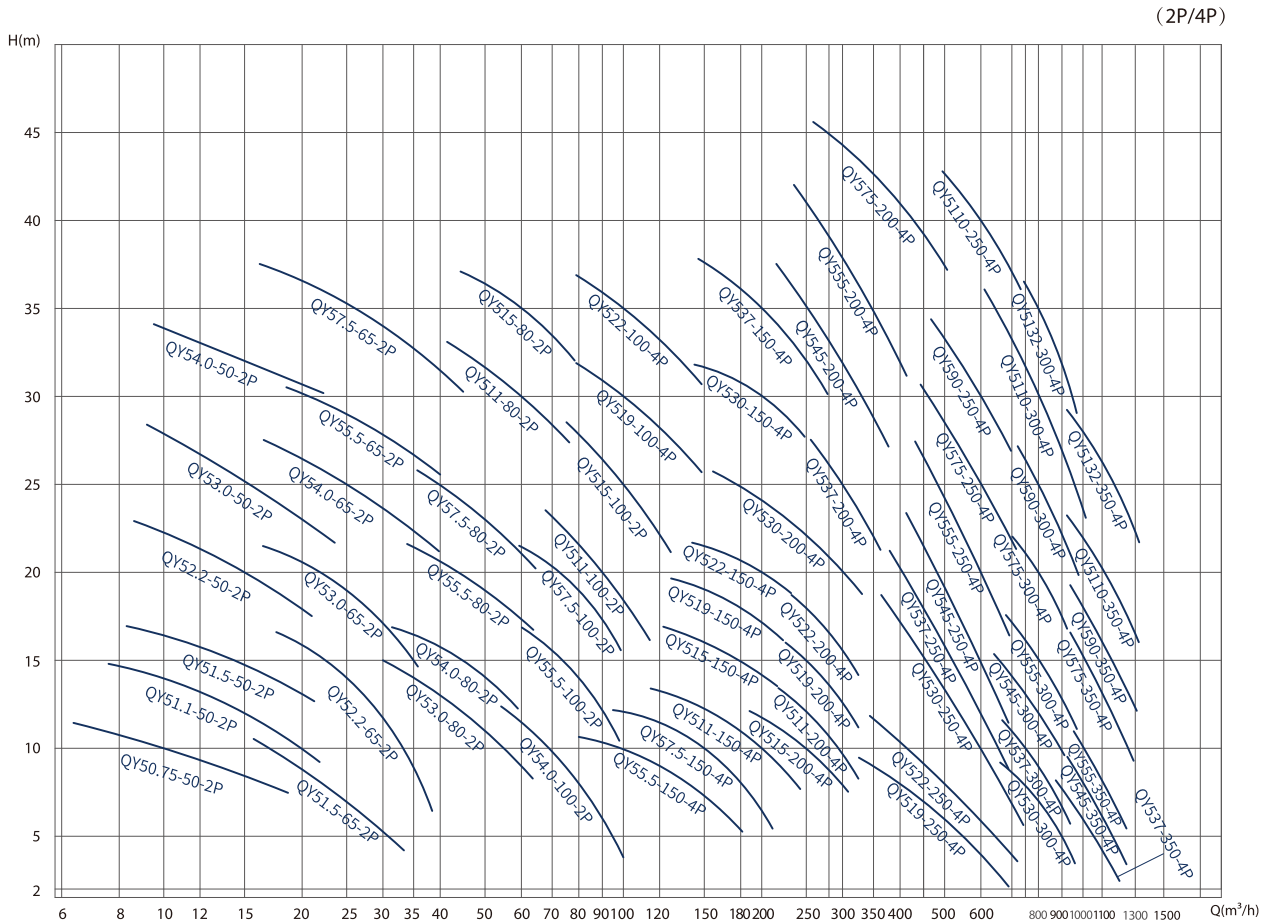

结构简图 Construction

NO.	名称 Name	材质 Material	
		GB	JIS
1	动力电缆 Power cable	NBR	NBR
2	锁紧螺母 Lock nut	06Cr19Ni10	SUS304
3	马达盖 Motor cover	HT200	FC200
4	上轴承座 Upper Bearing Housing	HT200	FC200
5	马达本体 Motor casing	HT200	FC200
6	定子 Stator	-	-
7	转子 Rotor	-	-
8	轴承 Bearing	-	-
9	中承座 Bracket	HT200	FC200
10	泵体 Pump casing	HT200	FC200
11	叶轮 Impeller	HT200	FC200
12	泵体底盖 Base Cover	HT200	SUS304

NO.	名称 Name	材质 Material	
		GB	JIS
13	吊环螺钉 Eye Bolt	06Cr19Ni10	SUS304
14	轴承 Bearing	-	-
15	主轴 Shaft	45#	S45C
16	机械密封 Mechanical seal	C-SiC	C-SiC
17	骨架油封 Shaft Seal	-	-
18	键 Key	12Cr17Mn6Ni5N	SUS201
19	叶轮螺母 Impeller Nut	12Cr17Mn6Ni5N	SUS201
20	固定架 Fixed frame	06Cr19Ni10	SUS304
21	引导管 Pail piping	06Cr19Ni10	SUS304
22	配合凸缘 Flange setter	HT200	FC200
23	着脱本体 Duckfoot	HT200	FC200

不同机型结构略有不同，可根据需求采用不同材质。

Different model has a little difference, materials can be selected according to the requirement of the customer.

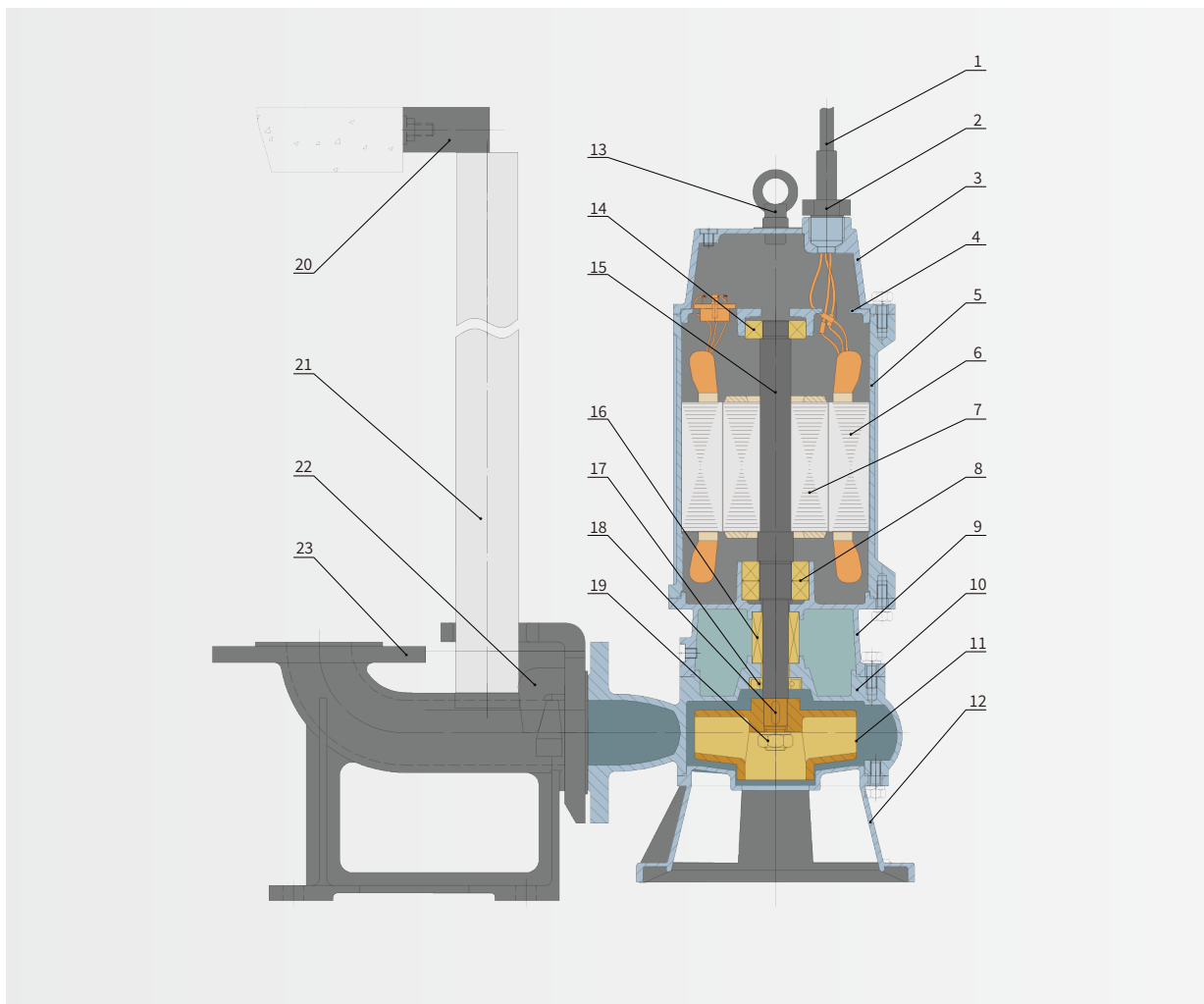

性能参数 Performance parameters

(2P/4P)

泵型号 Pump model	行业型号 Industry model	转速 Speed (r/min)	流量 Capacity (m ³ /h)	扬程 Head (m)	效率 Eff. η (%)	电机功率 Motor power (kW)	口径 Dia. (mm)	泵重量 Weight (kg)
QY50.75-50-2P	50QW10-10-0.75	2850	10	10	43%	0.75	50	22
QY51.1-50-2P	50QW15-12-1.1	2850	15	12	48%	1.1	50	23
QY51.5-50-2P	50QW15-15-1.5	2850	15	15	48%	1.5	50	28.5
QY52.2-50-2P	50QW15-20-2.2	2850	15	20	50%	2.2	50	34.5
QY53.0-50-2P	50QW15-25-3	2850	15	25	55%	3.0	50	39
QY54.0-50-2P	50QW15-32-4	2850	15	32	55%	4.0	50	57
QY51.5-65-2P	65QW25-7-1.5	2850	25	7	48%	1.5	65	29
QY52.2-65-2P	65QW25-14-2.2	2850	25	14	52%	2.2	65	35
QY53.0-65-2P	65QW25-19-3.0	2850	25	19	55%	3.0	65	39
QY54.0-65-2P	65QW25-25-4.0	2850	25	25	52%	4.0	65	58
QY55.5-65-2P	65QW25-29-5.5	2850	25	29	52%	5.5	65	64
QY57.5-65-2P	65QW30-34-7.5	2850	30	34	50%	7.5	65	88
QY53.0-80-2P	80QW50-11-3.0	2850	50	11	55%	3.0	80	40
QY54.0-80-2P	80QW50-14-4.0	2850	50	14	55%	4.0	80	57.5
QY55.5-80-2P	80QW50-19-5.5	2850	50	19	52%	5.5	80	64
QY57.5-80-2P	80QW50-23-7.5	2850	50	23	50%	7.5	80	90
QY511-80-2P	80QW60-30-11	2850	60	30	50%	11	80	100
QY515-80-2P	80QW60-35-15	2850	60	35	51%	15	80	108
QY54.0-100-2P	100QW80-9-4.0	2850	80	9	55%	4.0	100	60.5
QY55.5-100-2P	100QW80-14-5.5	2850	80	14	62%	5.5	100	67
QY57.5-100-2P	100QW80-19-7.5	2850	80	19	60%	7.5	100	92
QY511-100-2P	100QW90-20-11	2850	90	20	52%	11	100	100
QY515-100-2P	100QW100-25-15	2850	100	25	52%	15	100	110
QY519-100-4P	100QW100-30-18.5	1450	100	30	62%	18.5	100	270
QY522-100-4P	100QW100-35-22	1450	100	35	66%	22	100	282
QY55.5-150-4P	150QW120-9-5.5	1450	120	9	50%	5.5	150	110
QY57.5-150-4P	150QW150-10-7.5	1450	150	10	56%	7.5	150	125
QY511-150-4P	150QW180-11-11	1450	180	11	69%	11	150	181
QY515-150-4P	150QW180-15-15	1450	180	15	69%	15	150	202
QY519-150-4P	150QW180-18-18.5	1450	180	18	60%	18.5	150	265
QY522-150-4P	150QW200-20-22	1450	200	20	62%	22	150	275
QY530-150-4P	150QW200-30-30	1450	200	30	67%	30	150	420
QY537-150-4P	150QW200-35-37	1450	200	35	65%	37	150	440



性能参数 Performance parameters

(2P/4P)

泵型号 Pump model	行业型号 Industry model	转速 Speed (r/min)	流量 Capacity (m ³ /h)	扬程 Head (m)	效率 Eff. η (%)	电机功率 Motor power (kW)	口径 Dia. (mm)	泵重量 Weight (kg)
QY511-200-4P	200QW250-10-11	1450	250	10	70%	11	200	187
QY515-200-4P	200QW250-12-15	1450	250	12	70%	15	200	208
QY519-200-4P	200QW250-15-18.5	1450	250	15	70%	18.5	200	267
QY522-200-4P	200QW250-18-22	1450	250	18	67%	22	200	276
QY530-200-4P	200QW250-22-30	1450	250	22	65%	30	200	425
QY537-200-4P	200QW300-25-37	1450	300	25	66%	37	200	445
QY545-200-4P	200QW300-32-45	1450	300	32	67%	45	200	487
QY555-200-4P	200QW300-38-55	1450	300	38	67%	55	200	510
QY575-200-4P	200QW400-41-75	1450	400	41	62%	75	200	790
QY519-250-4P	250QW500-6-18.5	1450	500	6	55%	18.5	250	330
QY522-250-4P	250QW500-8-22	1450	500	8	61%	22	250	365
QY530-250-4P	250QW600-9-30	1450	600	9	63%	30	250	443
QY537-250-4P	250QW600-12-37	1450	600	12	65%	37	250	464
QY545-250-4P	250QW600-15-45	1450	600	15	62%	45	250	499
QY555-250-4P	250QW600-20-55	1450	600	20	69%	55	250	530
QY575-250-4P	250QW600-25-75	1450	600	25	67%	75	250	850
QY590-250-4P	250QW600-30-90	1450	600	30	63%	90	250	925
QY5110-250-4P	250QW600-40-110	1450	600	40	66%	110	250	1050
QY530-300-4P	300QW800-7-30	1450	800	7	54%	30	300	530
QY537-300-4P	300QW800-9-37	1450	800	9	60%	37	300	550
QY545-300-4P	300QW800-12-45	1450	800	12	62%	45	300	600
QY555-300-4P	300QW800-15-55	1450	800	15	64%	55	300	630
QY575-300-4P	300QW800-20-75	1450	800	20	73%	75	300	900
QY590-300-4P	300QW800-25-90	1450	800	25	67%	90	300	937
QY5110-300-4P	300QW800-30-110	1450	800	30	70%	110	300	1080
QY5132-300-4P	300QW800-35-132	1450	800	35	64%	132	300	1250
QY537-350-4P	350QW1000-6-37	1450	1000	6	60%	37	350	600
QY545-350-4P	350QW1000-8-45	1450	1000	8	65%	45	350	650
QY555-350-4P	350QW1000-10-55	1450	1000	10	65%	55	350	680
QY575-350-4P	350QW1000-15-75	1450	1000	15	62%	75	350	950
QY590-350-4P	350QW1000-18-90	1450	1000	18	62%	90	350	990
QY5110-350-4P	350QW1000-22-110	1450	1000	22	62%	110	350	1150
QY5132-350-4P	350QW1000-28-132	1450	1000	28	65%	132	350	1300



安装示意图 Installation sketch map

未附着脱
without autosetter



附着脱
with autosetter



欢迎索取以下产品型录

To find out more about following products, please visit www.gsd.net.cn

	泵系列 Pump Series	潜水泵系列 陆上泵系列 特种泵系列 Submersible pump series On land pump series Special pump series
	搅拌推流系列 Mixing and flow propeller	搅拌机系列 推流器系列 Mixing series Flow propeller series
	供氧曝气系列 Aeration equipment series	曝气机系列 曝气盘系列 曝气管系列 Aerator series Disc diffusers Tube diffusers
	风机系列 Blower Series	磁悬浮鼓风机 空气悬浮高速离心鼓风机 三叶罗茨鼓风机系列 Maglev turbo blower High-Speed centrifugal blower Three-lobe Roots Blower blower series
	污泥处理设备 Sludge treatment equipment	带式脱水机 厢式压滤机 叠螺式脱水机 污泥干化设备 浅层高效气浮设备 Belt filter press Box filter press Screw press Mud scraper Dissolved air flotation clarifier
	智能化系列 Intelligent series	智能设备 水务设备健康管理 水务系统工艺优化智能管理 Intelligent equipment Health management for water equipment Intelligent management for water system process
	反应器及套装设备 Reactor and package equipment	芬顿反应系统 MBR生物膜反应器 预制泵站 一体化污水处理设备 Fenton reaction system MBR biofilm reactor Prefabricated pumping station Intelligent Compact Unit
	耗材药剂及相关设备 Consumables, reagents and related equipment	生物绳 PAC 聚合氯化铝 PAM 聚丙烯酰胺 泡药设备 Biological rope PAC polyaluminum chloride PAM polyacrylamide Automatic dispensing dissolvers

GSD 的经营理念 Business Philosophy

G-Green 绿色 S-Safe 安全 D-Development 永续经营



川源(中国)机械有限公司
GSD (China) Co., Ltd.

水处理系统专业合作伙伴

Professional partners in water treatment systems

免费咨询电话

400-657-9066

川源(中国)机械有限公司版权所有 all rights reserved. CY-61

数据来源: 公司实验室数据及客户实际使用数据, 具体使用环境不同, 数据可能存在差异。本型录内容如有变更, 恕不另行通知。

The data on the brochure is based on the laboratory testing data and customers' actual operation data in the past. The actual data may be different in different application conditions. We reserve the right to change content without notice.

